

## ATP Surface Swab

### USER MANUAL

Product No.:YL0001/ YL0002

### Overview

ATP is the abbreviation of the chemical substance adenosine triphosphate. It is commonly found in all living cells including microorganisms. Its main function in the cell is to provide energy.

Based on the principle of firefly luminescence, the "luciferase-luciferin system" can be used to quickly detect the ATP content in the test environment, making it easier to monitor the hygienic status of the surface of processing equipment and other various industrial environments.

Under the catalysis of luciferase, ATP present in the sample reacts with luciferin to produce fluorescence, and the fluorescence intensity (RLU) is proportional to the ATP content. The higher the RLU value, the higher the ATP content and the dirtier the surface.

### Applicable Scope

Surface of the target subject.

### Kit Composition

Composition	Quantity
ATP Surface Swab	100 tests
Instruction	1 copy

### Applicable Instruments

Luminometer+Swab	Sensitivity
YZ3500+YL0002	$5 \times 10^{-16}$ mol
YZ3000L+YL0002	$10^{-15}$ mol
YZ3000+YL0001	$10^{-15}$ mol

### Operation Procedure

- 1) Turn on the instrument's power, and wait for the main interface to load. Tap on the Detection icon to enter the detection interface, set the threshold and the operator's name for future reference.
- 2) Before using the ATP swab, equilibrate the swab under refrigerated conditions to **room temperature (21–25°C)**, holding the swab firmly, twist and pull the top of the swab out of the tube.
- 3) Thoroughly swab a standard **10 x 10 cm area** in a Z-shape wiping, after the sampling is completed, put the swab back into the swab tube.
- 4) Hold the swab tube firmly and break the snap-valve by bending the bulb back and forth. Squeeze the bulb twice to release all the liquid down the swab shaft.
- 5) Bathe the swab bud in the liquid by shaking for 10 seconds. Once activated, the sample must be read in the luminometer within 30 seconds.
- 6) Quickly put the swab into the Luminometer. Close the testing cabin and click the **"Test"** button on the screen to perform the test. The test results will be displayed on the interface.

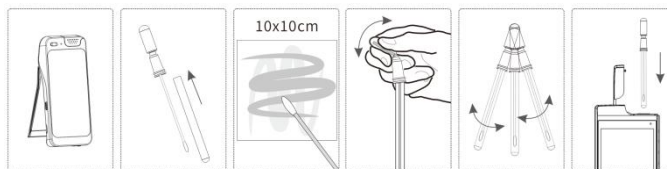

### Note

- Do not touch the swab or inside the sampling device with your fingers.
- While collecting the sample, rotate the swab to maximize the amount of sample collected at the tip of the swab.
- Apply enough pressure to bend the swab shaft.

- Keep the instrument upright.

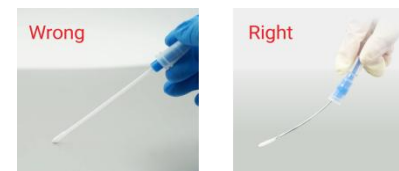

### Interpretation Results

- The ATP Surface Swab is used with the YZ3500, YZ3000L or YZ3000 Luminometer. Thresholds and readings can be interpreted according to the table below.
- "Pass" is considered clean, "Caution" is not clean enough, and "Fail" is considered dirty.

Luminometer	Threshold	Result
YZ3500	0-20	Pass
	20-60	Caution
	>60	Fail
YZ3000L/YZ3000	0-10	Pass
	10-30	Caution
	>30	Fail

### Storage and Validity

2-8°C , store away from light, valid for 12 months.

### Manufacturer : Elaboric Biotechnology Co., Ltd.

Address: Building 10, No.58 Shenzhen West Road, Kuishan Sub-district, Economic Development Zone, Rizhao City, Shandong Province, China.

Email: info@yili-bio.com Tel: +86 532 55678026

www.yili-bio.com